

# **УПЪТВАНЕ ЗА WI-FI УПРАВЛЕНИЕ**

## **MIDEA Smart Kit**

### **ВАЖНО:**

Прочетете внимателно ръководството, преди да инсталирате или свържете вашия Smart kit (безжичен модул). Не забравяйте да запазите това ръководство за бъдещи справки.



# СЪДЪРЖАНИЕ

❶	Спецификации.....	2
❷	Инсталация на модула.....	3
❸	Инсталация на приложението.....	4
❹	Подготовка.....	4
❺	Конфигурация на мрежата.....	5
❻	Как да използвате приложението.....	9
❼	Специални функции.....	12
❽	Декларация за съответствие.....	18

## ПРЕДПАЗНИ МЕРКИ

- **Поддържани операционни системи: iOS, Android**
  - Моля, поддържайте приложението си актуално с най-новата версия.
  - Поради особена ситуация, които могат да възникнат, ние изрично заявяваме: Не всички версии и разновидности на Android и iOS са съвместими с приложението. Ние няма да носим отговорност за никакви проблеми в резултат на несъвместимостта.
- **Стратегия за безжична безопасност**

Smart kit поддържа само WPA-PSK/WPA2-PSK криптиране или никакво криптиране.  
Препоръчва се WPA-PSK/WPA2-PSK криптиране.

## ● Предупреждение

- Поради различни мрежови условия, процесът на управление може да се прекъсне. Ако възникне тази ситуация, екранът на приложението може да показва неактуална информация, моля, не се чувствайте объркани.
- Камерата на смартфона трябва да е 5MP или повече, за да сте сигурни, че ще се сканира QR кода.
- Поради различни мрежови конфигурации, понякога може да възникне изчакване на заявката, поради което е необходимо да направите мрежова конфигурация отново.
- Приложението подлежи на актуализиране без предварително известие за подобряване на функцията на продукта. Действителният процес на конфигуриране на мрежата може да е малко по-различен от наръчника.
- Моля, проверете уебсайта на услугата за повече информация.

## 1 СПЕЦИФИКАЦИИ

**Модел:** EU-SK105, US-SK105, EU-SK106, US-SK106

**Стандарт:** IEEE 802.11b/g/n

**Тип антена:** Печатна PCB антена

**Честотна лента:** 2400 - 2483.5MHz

**Работна температура:** 0 C ~ 45 C °

**Работна влажност:** 10% ~ 85%

**Входяща мощност:** DC 5V/500mA

**Максимална мощност на TX:** <20dBm

## 2 ИНСТАЛАЦИЯ НА МОДУЛА

**БЕЛЕЖКА:** Ако Smart Kit е инсталиран в климатика, следващите стъпки не са нужни.

- 1) Свалете капачката на Smart Kit.

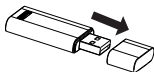

- 2) Отворете предния панел на климатика и поставете Smart Kit в USB порта.
- 3) Залепете QR кода, опакован със Sart Kit, към страничния панел на лиматика или на друго удобно място. Уверете се, че е удобно да бъде сканиран с мобилен телефон.

**Идея:** По-добре е да запазите другите два QR кода на сигурно място или да им направите снимка и да я запишете в своя телефон.

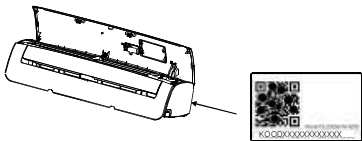

**ВНИМАНИЕ:** Този интерфейс е съвместим само със Smart Kit (безжичен модул), предоставен от производителя.

### 3 ИНСТАЛАЦИЯ НА ПРИЛОЖЕНИЕТО

В Google Play Store или Apple App Store) потърсете „MSmartHome“. Изтеглете и инсталирайте приложението MSmartHome. Можете също да изтеглите приложението, като сканирате QR кода:



### 4 ПОДГОТОВКА

- Fheymikrlhfhbegrhmkllhcklh□  
ktaghdttfLlLmllhkgllhLlLmll□  
kktaekbgllglibbatrb□  
bklpbygihlblebdhgnbmbgg□  
fl□
- Mikrlhfhbegrhmkllhcklh□  
ktaghdttfLlLfdhlylhbkdl□  
baihealHkgllhlylfoql□  
mbgihohysbLlLfbkemcl□  
ebyylgihpkgdhgnbmbg□

## **5** NETWORK CONFIGURATION

### **Cautions**

- It is necessary to forget any other around network and make sure the Android or iOS device just connect to the Wi-Fi/Wireless network you want to configure.
- Make sure the Android or iOS device Wi-Fi/Wireless function works well and can be connected back to your original Wi-Fi/Wireless network automatically.

### **Kindly reminder:**

User must finish all the steps in 8 minutes after powering on AC, otherwise you need to power on it again.

## Register and log in

Open the MSmarHome app, and create a new account to start ( you can also register through a third-party account). If you already had an existing account, use the account to log in.



## Connect your devices to MSmarHome

1. Please make sure your mobile phone is connected to Wi-Fi. If not, go to Settings and turn on the wireless connection, select and connect to a Wi-Fi. Also please turn on the Bluetooth on your phone. If not, go to Settings and turn it on.
2. Please power on your devices.
3. Open MSmarHome app on your phone.
4. If a message of "Smart devices discovered nearby" appears, click to add.





5. If no message appears, select "+" on the page and select your device in the list of nearby devices available. If your device is not listed, please add your device manually by the device category [Air Conditioner] and device model [Split AC].

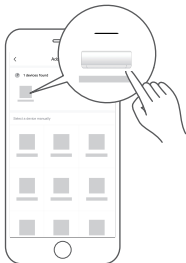

6. Connect your device to Wi-Fi according to the instructions on app. If the connection fails, please follow the instructions provided by the app to continue with the operation.



**NOTE:**

- Make sure your devices are powered on.
- Keep your mobile phone close enough to your device when you are connecting network to your device.
- Connect your mobile phone to the wireless network at home, and make sure you know the password of the Wi-Fi.
- Check if your router supports 2.4 GHz Wi-Fi band and turn it on. If you are not sure whether the router supports 2.4 GHz band, please contact the router manufacturer.
- The device cannot connect to the Wi-Fi that requires authentication, and it usually appears in public area such as hotels, restaurants, etc. Please connect to a Wi-Fi that does not require authentication.
- It is recommended to use a Wi-Fi name that only contains letters and numbers. If your Wi-Fi name contains special characters, please modify it in the router.
- Turn off the WLAN+ (Android) or WLAN Assistant (iOS) function of your mobile phone when connecting network to your devices.
- In the case that your device connected to Wi-Fi before but it needs to reconnect, please click "+" on app Home page, and add your device again by the device category and model according to the instructions on app.

## 6 HOW TO USE APP

Please ensure both your mobile device and air conditioner are connected to the Internet before using app to control the air conditioner via internet, please follow the next steps:

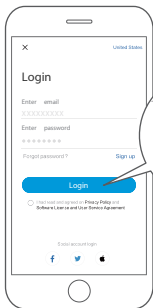

① Click "Login "

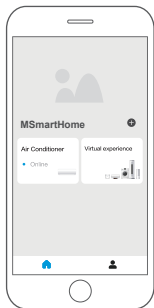

② Choose the Air Conditioner.

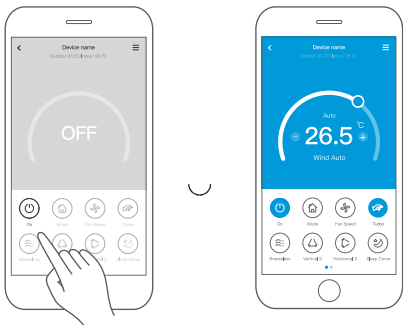

- ③ Thus, user can control air conditioners on/off status, operation mode, temperature, fan speed and so on.

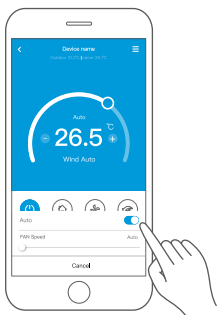
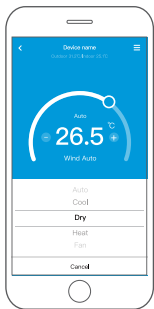

**NOTE:**

Not all the function of the APP is available on air conditioner. For example: ECO, Turbo, Swing function, please check the user manual to find more information.

## 7 SPECIAL FUNCTIONS

Including: Schedule, Sleep Curve, Energy Monitor, Bill Control and Check.

### NOTE:

No all the unit can use these special function on the APP. Thus, if the air conditioner do not support the above function, the function will be hid from the function list.

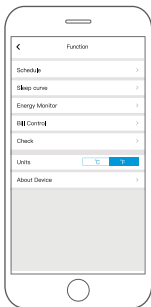

## ■ Schedule

Weekly, user can make an appointment to turn on or off AC on specific time. User also can choose circulation to keep the AC under schedule control every week.

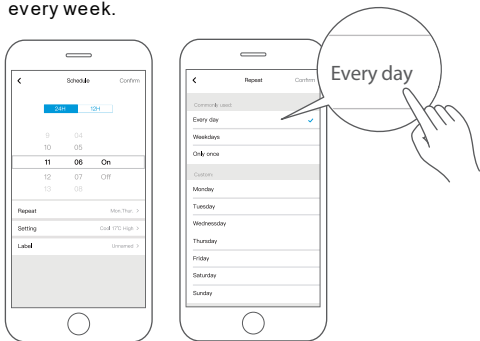

## ■ Sleep Curve

User can customize their own comfortable sleep by setting target temperature.





## ■ Energy Monitor

User can simply monitor the electricity consumption of AC unit by checking the chart and history record.

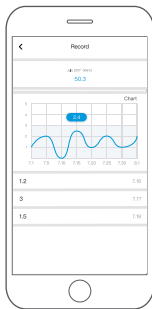

## ■ Bill Control

User can set parameters to limit the electricity consumption over a period of time.

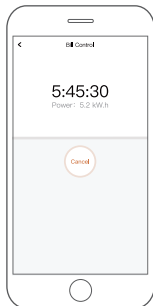

## ■ Check

User can simply check the AC running status with this function. When finishing this procedure, it can display the normal items, abnormal items, and detail information.

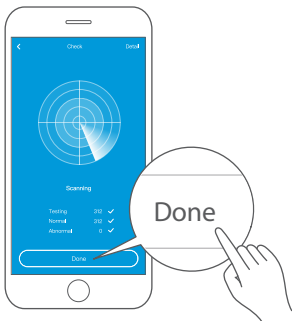

## **8 APP DECLARATION**

Hereby, we declare that this Smart kit is in compliance with the essential requirements and other relevant provisions of Directive 2014/53/EU. A copy of the full DoC is attached. (European Union products only)

### **CAUTIONS:**

#### **WIFI module models: US-SK105,EU-SK105:**

FCC ID: 2ADQOMDNA21

IC: 12575A-MDNA21

#### **WIFI module models: US-SK106,EU-SK106:**

FCC ID: 2ADQOMDNA22

IC: 12575A-MDNA22

This device complies with Part 15 of the FCC Rules and it contains licence-exempt transmitter(s)/receiver(s) that comply with Innovation, Science and Economic Development Canada's licence-exempt RSS(s).

Operation is subject to the following two conditions:

- (1) This device may not cause harmful interference; and
- (2) This device must accept any interference, including interference that may cause undesired operation of the device.

Only operate the device in accordance with the instructions supplied.

Changes or modifications to this unit not expressly approved by the party responsible for compliance could void the user's authority to operate the equipment.

This device complies with FCC radiation exposure limits set forth for an uncontrolled environment. In order to avoid the possibility of exceeding the FCC radio frequency exposure limits, human proximity to the antenna shall not be less than 20cm (8 inches) during normal operation.

### **In Canada:**

CAN ICES-3(B)/NMB-3(B)

Le présent appareil est conforme aux CNR Innovation, Sciences et Développement économique Canada applicables aux appareils radio exempts de licence.

L'exploitation est autorisée aux deux conditions suivantes:

(1) il ne doit pas produire de brouillage et (2) l'utilisateur du dispositif doit être prêt à accepter tout brouillage radioélectrique reçu, même si ce brouillage est susceptible de compromettre le fonctionnement du dispositif.

Cet émetteur ne doit pas être Co-placé ou ne fonctionnant en même temps qu'aucune autre antenne ou émetteur.

Cet équipement devrait être installé et actionné avec une distance minimum de 20 millimètres entre le radiateur et votre corps.

**NOTE:** This equipment has been tested and found to comply with the limits for a Class B digital device, pursuant to part 15 of the FCC Rules. These limits are designed to provide reasonable protection against harmful interference in a residential installation. This equipment generates, uses and can radiate radio frequency energy and, if not installed and used in accordance with the instructions, may cause harmful interference to radio communications. However, there is no guarantee that interference will not occur in a particular installation. If this equipment does cause harmful interference to radio or television reception, which can be determined by turning the equipment off and on, the user is encouraged to try to correct the interference by one or more of the following measures:

- Reorient or relocate the receiving antenna.
- Increase the separation between the equipment and receiver.
- Connect the equipment into an outlet on a circuit different from that to which the receiver is connected.
- Consult the dealer or an experienced radio/TV technician for help.



**Importer:xxxxx**

**Manufacturer:**

GD Midea Air-Conditioning Equipment Co.,Ltd.  
Lingang Road Beijiao Shunde Foshan  
Guangdong People's Republic of China 528311

**Company will not be liable for any issues  
and problems caused by Internet, Wireless  
Router and Smart Devices. Please contact  
the original provider to get further help.**

CS376U-APP(SK105-OBM-Msmart)  
16110800000568  
20220218



# 此页内容无需印刷

技术要求：  
铜版纸105克，  
74mm\*105mm  
彩色印刷

## 备注：

基准说明书为单英文版，封底只有制造商信息，进口商信息需根据实际客户信息填写，无欧盟区域DOC内容，只是兼容了欧盟RED指令信息和北美 FCC指令等内容。

业务应根据销售的区域及客户要求，通知制单工程师对内容进行修订，欧盟地区需要由业务添加DoC合规声明文件（建议放在说明书倒数第二页），将完整说明书电子档提交给制单。